



Toyota Power Foldout Guide

7-1-19



Toyota Power Foldout Features

Bigger is better. BraunAbility designed its Toyota Power Foldout with an additional six inches of cabin length for just-right maneuverability, without sacrificing ride quality or vehicle handling.

Foldout Ramp - The rigid, heavy duty (1,000lb capacity) power foldout ramp can easily deploy onto a curb for greater parking flexibility.

Interior Space - Extra interior space for easy maneuverability.

Smooth Ride - Unaltered ride and handling maintains the best-in-class driving experience of the Toyota Sienna.

Footrest - Full-length stow-away footrest for 3rd row passenger comfort.

Lighting - Lighting throughout rear of vehicle for easier navigating in the dark.



Toyota Power Foldout Features

Toyota Power Foldout (XL) ► 2017-2020 Toyota Sienna

See back of this guide for vehicle requirements.



◀ Lowered Floor

The floor is lowered from the toe pan to the rear axle and provides 6" of additional length over the 2015-2016 model.

Automatic Door

The OEM Toyota power door operator opens the sliding door at the touch of a button.



◀ Power Foldout Ramp

The lightweight power foldout ramp offers unparalleled ease of access for wheelchair and scooter users.

Custom Ground Effects

Adds stylish lines and enhances smooth OEM appearance.



◀ Automatic Kneeling Rear Suspension

The vehicle features a kneeling system to make boarding even easier. An actuator lowers the rear suspension while the door opens, which reduces the slope of the automatic ramp. The system can be de-activated when desired with the on/off switch.

Integrated Keyfob Remote ►

Control of the vehicle's accessible features is built into the Toyota keyfob remote. Quick-touch operation assures simple, convenient and reliable operation. Two keyfobs are included with the vehicle.

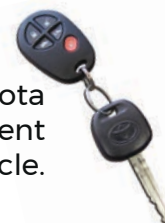

◀ Fold-Down Footrest

Adds comfort for backseat passengers and folds away when not in use.

OEM-Style Switches ►

Operational switches are conveniently located throughout the interior for wheelchair users' convenience. The switches resemble the OEM style and appearance.



◀ Rear Cargo Area

The spare tire is now stored below the rear cargo area. Third row roll-and-tumble seats fold forward to offer additional cargo space when needed.

◀ "Step & Roll" Front Passenger Seats

The driver and passenger seats can be easily removed to provide wheelchair securement positions in the front of the vehicle.



Wheelchair/Occupant Securement System

One belt system is included for use with the floor-mounted tracks.

Toyota Power Foldout Dimensions

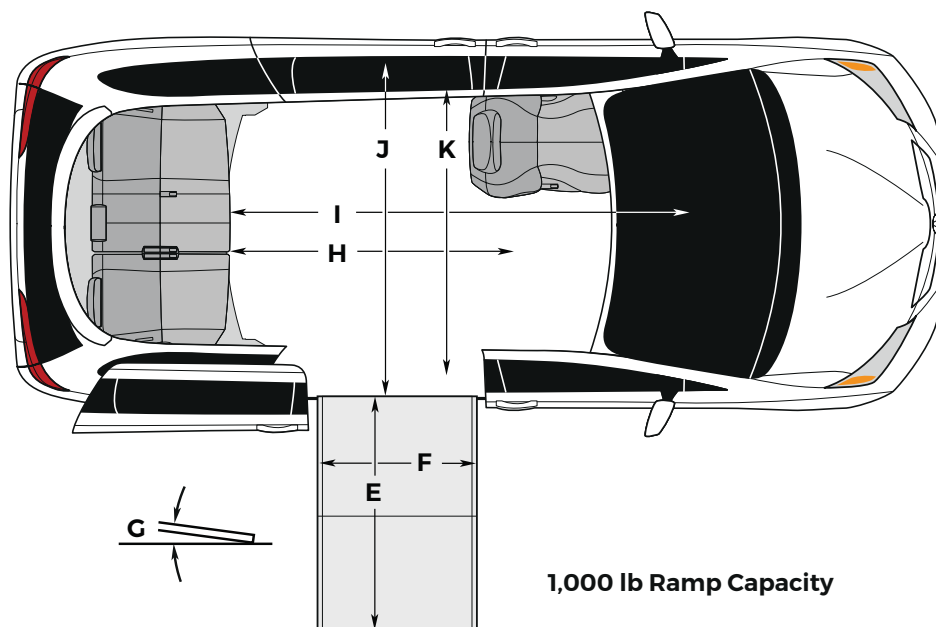
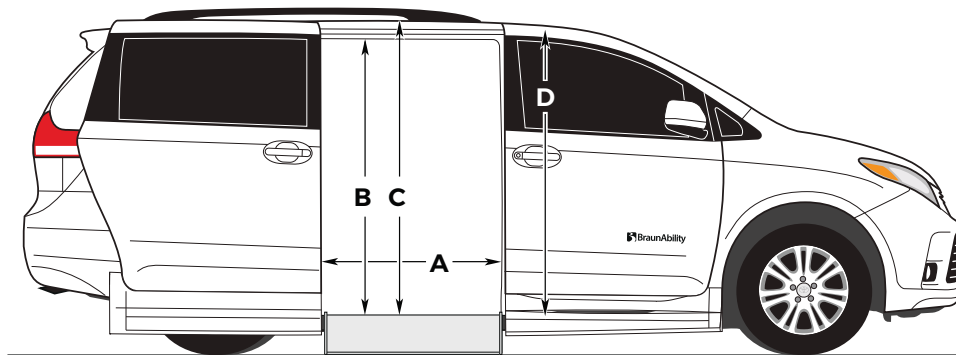

All dimensions are for reference only.

| | Foldout Ramp | |
|--|--------------|-----------------|
| Door Opening Usable Width | A | 31" |
| Door Opening Usable Height 1) at Middle of Door 2) at Airbag | B | 1) 56" 2) 55.5" |
| Interior Height at Center of Vehicle* | C | 60.5" |
| Interior Height at Driver and Passenger Position** | D | 59.5" |
| Ramp Length | E | 52" |
| Ramp Width (Usable Clear Opening) | F | 29.25" |
| Ramp Angle (with Vehicle Kneeled)*** | G | 7.25° |
| Interior Floor Length (Behind Front Seat Strikers) | H | 57" |
| Overall Interior Floor Length | I | 89.25" |
| Interior Width at Slide Doors (Doors Closed) | J | 65" |
| Interior Width at B Pillars | K | 59" |

Due to manufacturing tolerances both with the OEM vehicle and the conversion components, all dimensions may vary slightly from those shown.

* Deduct 2" off of interior height for applications with overhead DVD/rail system

** Deduct 1" off of interior height for applications with moon roof

*** Ramp angle subject to 1.5 degree variance based on chassis trim level and other environmental factors - measured with a 250 lb approximated wheelchair passenger load at the center of the ramp

Toyota Power Foldout Options

Available factory installed at time of order, or for ship-out (unless otherwise noted).

Rubber Flooring

Substitute rubber flooring in lieu of carpet.
(NOT AVAILABLE FOR SHIP-OUT - FACTORY INSTALLED)
(MUST BE ORDERED PRIOR TO PRODUCTION)



- ◀ **E90432KLGKNS** **Extra Wheelchair/Occupant Securement System - with Bag**
Includes four wheelchair tie-downs, one lap belt/shoulder harness connector and bag. One system is included standard.



- ◀ **E50430AKS** **EZ Lock Tie-Down Mounting Plate**
Allows for mounting of EZ Lock Tie-Down in front mounting location, bolts to weld nuts already in floor assembly.



- ◀ **33774NKS** **Multi Piece Chest and Waist Belt**
Interfaces with standard and optional wheelchair securement systems to facilitate proper occupant restraint with a wide variety of wheelchair configurations.

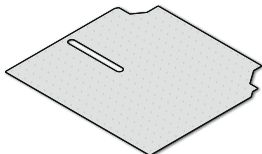

- ◀ **EC90193** **Protective Carpet Mat** Infloor Ramp - with Track Cutout
E90450 **Protective Carpet Mat** Foldout Ramp - with Track Cutout
Clear plastic mat protects carpet from traffic wear.



- ◀ **26558** **Retractable Securement Belts**
Deluxe Kit, with Tensioning Knobs (4)



- ◀ **501100NKS** **Rigid Cable Extension for Lap Belt/Shoulder Harness (1st Row)**
E90366LGKNS **Rigid Cable Extension for Lap Belt/Shoulder Harness (2nd Row)**
Connects to floor-mounted tie-down track, stands rigid for use with lap belt/shoulder harness.

- E50709A_S-08KS** **Striker Covers (Pair)**
Covers seat strikers when seat is not used.
Kit includes two covers for one seating position.

Vehicle Information

Vehicle must be equipped with the OEM power door.

Vehicle must not have AWD (All Wheel Drive).

Before ordering or drop-shipping a vehicle, we strongly recommend contacting BraunAbility for guidance in deriving payload capacities and selecting equipment and seating options before you purchase the vehicle.

BraunAbility will only convert 2017-2020 Toyota Sienna with 50,000 or less miles. Vehicle must be in sound condition and must never have been involved in an accident. All vehicles are inspected and subject to acceptance/rejection upon arrival at the BraunAbility plant.

Safety has always been a top priority at BraunAbility. The Toyota Power Foldout has been crash tested and certified to meet or exceed all applicable requirements of the Federal Motor Vehicle Safety Standards (FMVSS) and is backed by our 3 year/36,000 mile limited and 5 year/unlimited mile rust-through metal protection on every vehicle that leaves the factory. Add to this the original Toyota warranty for unconverted parts and a nationwide dealer network, and you can rest assured BraunAbility will be there to support you no matter where your travels take you.



braunability.com

800.THE.LIFT

ISO 9001:2015

631 West 11th Street, Winamac, IN 46996, USA